



THE LONDON BOROUGH  
www.bromley.gov.uk

BROMLEY CIVIC CENTRE, STOCKWELL CLOSE, BROMLEY BRI 3UH

TELEPHONE: 020 8464 3333

:

CONTACT: Lisa Thornley

[lisa.thornley@bromley.gov.uk](mailto:lisa.thornley@bromley.gov.uk)

DIRECT LINE: 020 8461 7566

FAX: 020 8290 0608

DATE: 19 July 2013

## PLANS SUB-COMMITTEE NO. 4

Meeting to be held on Thursday 25 July 2013

### SUPPLEMENTARY AGENDA

**THE CHAIRMAN TO MOVE THAT THE ATTACHED REPORT, NOT INCLUDED IN THE PUBLISHED AGENDA, BE CONSIDERED AS A MATTER OF URGENCY ON THE FOLLOWING GROUNDS:**

The school term ends during the week beginning 22 July and confirmation is sought that the manufacturer can be instructed to proceed with construction of the canopy. Access arrangements with advanced notice for the installation of the canopy is also required.

Report No.	Ward	Page No.	Application Number and Address
8	Chislehurst	1-4	(13/02024/FULL1) - Mead Road Infant School, Mead Road, Chislehurst

*Copies of the documents referred to above can be obtained from*  
[www.bromley.gov.uk/meetings](http://www.bromley.gov.uk/meetings)

This page is left intentionally blank

# Agenda Item 8

SECTION '1' – Applications submitted by the London Borough of Bromley

**Application No :** 13/02024/FULL1

**Ward:**  
**Chislehurst**

**Address :** Mead Road Infant School Mead Road  
Chislehurst BR7 6AD

**OS Grid Ref:** E: 544184 N: 170941

**Applicant :** Mr C Freese

**Objections :** NO

## **Description of Development:**

Erection of canopy

Key designations:

Conservation Area: Chislehurst

Biggin Hill Safeguarding Birds

Biggin Hill Safeguarding Area

Green Belt

London City Airport Safeguarding

London City Airport Safeguarding Birds

## **Proposal**

The proposed structure will be situated at the rear of the school buildings and toward the western side of the site, 3.5m away from the western site boundary. It will occupy an existing tarmacked area and measure approximately 6m x 10m in area. The canopy will be supported by six posts and rise to a maximum height of approximately 3.3m.

A supporting letter accompanying the application advises that at present the school has no covered outdoor space which violates the Government's "criteria for schools to provide an indoor/outdoor teaching environment/area" and, furthermore, that this goes against "Health & Safety" provisions.

## **Location**

The site is situated along the northern side of Mead Road within what is a predominantly residential area. The site falls within the Chislehurst Conservation Area.

## **Comments from Local Residents**

No comments were received from local residents at the time that this report was compiled.

## Comments from Consultees

No technical objections have been raised.

## Planning Considerations

Relevant Unitary Development Plan Policies are BE1 (Design of New Development) and BE11 (Conservation Areas).

## Planning History

There is no planning history relevant to this application.

## Conclusions

The main issues relating to the application are the effect that it would have on the character and appearance of the Chislehurst Conservation Area and the impact that it would have on the amenities of the occupants of surrounding residential properties.

Although the proposed structure will occupy a sizeable area, the space will remain largely open and will be accessible from the surrounding playing areas. It will, to a large extent, be screened from the adjacent property by trees and hedges straddling the western site boundary. Accordingly, it is not considered that the character and appearance of the surrounding area will be significantly affected.

Having had regard to the above it was considered that the development in the manner proposed is acceptable in that it would not result in a significant loss of amenity to local residents nor impact detrimentally on the character of the Conservation Area.

Background papers referred to during production of this report comprise all correspondence on file ref. 13/02024, excluding exempt information.

## **RECOMMENDATION: GRANT PERMISSION WITH/WITHOUT CONDITIONS**

- |   |        |  |
|---|--------|--|
| 1 | ACA01  | Commencement of development within 3 yrs |
|   | ACA01R | A01 Reason 3 years                       |
| 2 | ACK01  | Compliance with submitted plan           |
|   | ACC03R | Reason C03                               |

**Application:**13/02024/FULL1

**Address:** Mead Road Infant School Mead Road Chislehurst BR7 6AD

**Proposal:** Erection of canopy

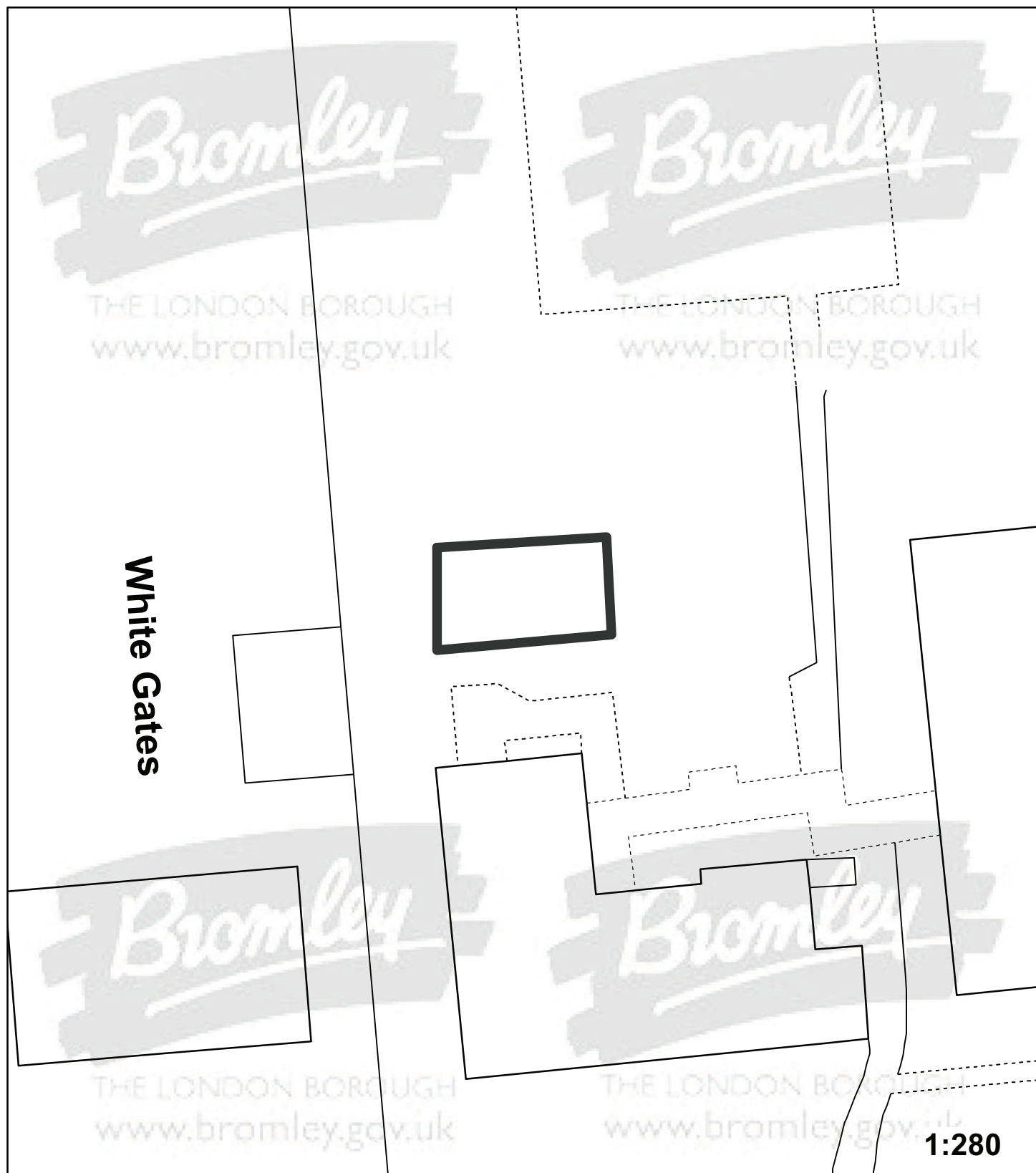

"This plan is provided to identify the location of the site and should not be used to identify the extent of the application site"

This page is left intentionally blank